

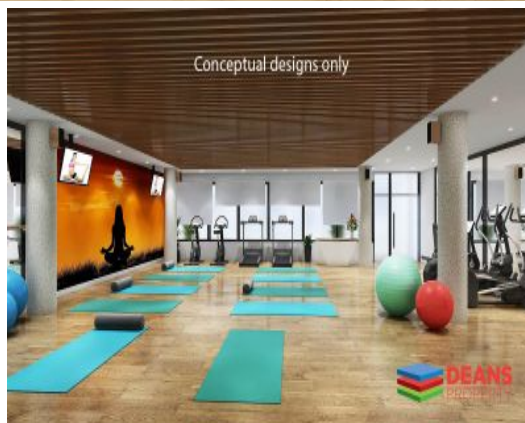

Conceptual designs only

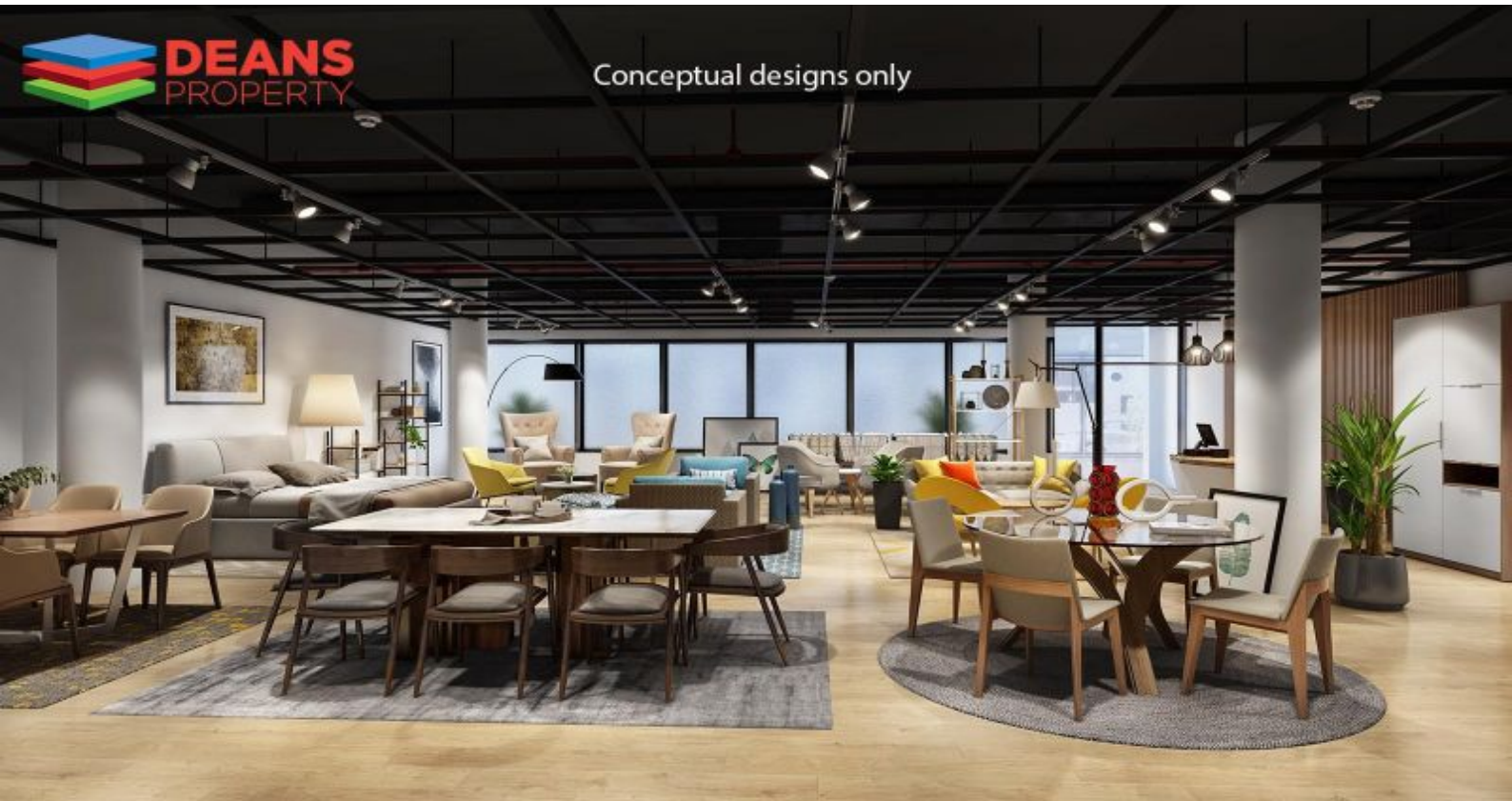

## EXCELLENT EXPOSURE - SHOWROOM/OFFICE/RETAIL !

- Deans Property is proud to present 3 brand new ground floor suites in Glebe's newest Residential Apartment Complex. The building features 99 brand new 1, 2& 3-Bedroom apartments spread over a seven-story building with a rooftop terrace. Prominently located on the corner of Bay & Wentworth Street, these rare opportunities offer excellent exposure to passing vehicles and foot traffic. The local surroundings of Glebe & Ultimo are well known for being one of Sydney's major education precincts (University of Sydney, UTS, University of Notre Dame & International Grammar School), sitting alongside the development of approximately 700 new residential apartments, the population increase is yet to soar with an immediate demand for a local retail provider.

Features include:

- 251 sqm suite with shopfront out onto Wentworth Street
- Concrete floors & 3.5 high metre ceilings
- Floor to ceiling glass windows
- Multi-functional

### Price

Contact Agent

### Property Details

Type	Commercial
Property Type	Offices
Area	251m2

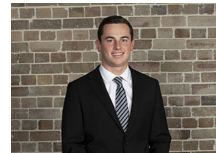

Jackson Deans-Harvey  
P : 9282 6777  
M : 0449 877 100  
E : jackson@deansproperty.com.au



Louise Hoban  
P : 0422 519 453  
M : 0422 519 453  
E : lhoban@deansproperty.com.au

